



SAM ALLEN WHOLESALE

National Distributor of

SHURflo®

Pentair Water



SHURFLO

marine plumbing systems

SHURflo has been the marine industry's leading plumbing supplier for more than 20 years. Through innovative product design, superior service and close customer relationships, SHURflo's solutions support the growth of the marine industry and ensure the satisfaction of boaters around the world.

SAM ALLEN WHOLESALE

about us

(As quoted Mr Brendan Pudney - SHURflo Products Sales Manager Aust & NZ)

“Sam Allen leads a strong and successful business by delivering great customer support. Sam’s efforts in forming long term strategic product distribution partnerships with top quality market endorsed products, and leading a strong customer service team, by focusing on exceptional service to all their customers over many years. This appointment has helped to support SHURflo ‘trade end-users’ in Australia with both the stock range and supply service necessary to keep the marine industry sailing towards a successful and safe future.”

Sam Allen Wholesale aim to bring their customers the whole range of marine SHURflo products at an improved price structure. The sales team at SAW have many years experience with SHURflo products and look forward to sharing that knowledge with all of their customers.

For more information please email sales@samallen.com.au or phone 07 3902 7222.



www.samallen.com.au

sales@samallen.com.au

CONTENTS PAGE

FRESH WATER pumps

PAGE **1**



SALTWATER WASHDOWN pumps

PAGE **2**



LIVEWELL pumps

PAGE **3**



BLOWERS in-line

PAGE **3**



BILGE pumps

PAGE **4**



WATERGUARD™ filtration

PAGE **5**



PUMP fittings & DRILL pump

PAGE **5**



WATER SYSTEM accessories

PAGE **6**



SPARE parts

PAGE **6**



FRESH WATER pumps



3 YEAR WARRANTY

Aqua King™ Fresh Water Pumps

The Next Generation SHURflo pumps guarantee quiet operation and smooth performance while providing the ultimate in durability and reliability. Designed and built specifically for the harsh marine environment, the Next Generation SHURflo pumps are equipped with sealed switches and seamless e-coated motors. Thermally Protected. Ignition Protected.

Specifications: Intermittent Duty Multi-Fixture Application.



SAW Part No.	SHURflo Part No.	Name	Voltage	Dimensions	Flow Rate	Amps (Max)	Shut-Off Pressure	R.R.P
23934	3901-0206	Aqua King Standard 3.0	12 VDC	7.3" x 5.0" x 4.6" (184 x 127 x 118mm)	3.0 GPM (11.35 LPM)	5	55 PSI (3.5 BAR)	\$193.60
23935	3901-1206	Aqua King Standard 3.0	24 VDC	7.3" x 5.0" x 4.6" (184 x 127 x 118mm)	3.0 GPM (11.35 LPM)	3	55 PSI (3.5 BAR)	\$235.90
23933	2901-0213	Aqua King Junior 2.0	12 VDC	7.3" x 5.0" x 4.6" (184 x 127 x 118mm)	2.0 GPM (7.6 LPM)	4	30 PSI (2.0 BAR)	\$162.90

3 YEAR WARRANTY

Extreme™ Series Smart Sensor™ 5.7



The Smart Sensor™ 5.7 is a micro processor control based variable speed pump that delivers over 5 GPM and pressure up to 60 PSI. SHURflo's Smart Sensor™ 5.7 precisely monitors your system's water pressure and adjusts the motor speed, thus eliminating the need for a pressure switch. The corrosion resistant coated seamless motor shell and protected electronic package make the Smart Sensor™ capable of handling the harsh marine environment. Thermally Protected. Ignition Protected.

Specifications: Seamless Shell w/Electro-Coating. Variable Speed, Multi-Fixture.



SAW Part No.	SHURflo Part No.	Voltage	Dimensions	Flow Rate	Amps (Max)	Shut-Off Pressure	R.R.P
23949	5901-0211	12 VDC	9.25" x 5.00" x 5.50" (235 x 127 x 121mm)	5.0 GPM (18.9 LPM)	12	60 PSI (4.1 BAR)	\$557.20
23951	5901-1201	24 VDC	9.25" x 5.00" x 5.50" (235 x 127 x 121mm)	5.0 GPM (18.9 LPM)	5	60 PSI (4.1 BAR)	\$553.60

1 YEAR WARRANTY

Extreme™ Series High Flow Strainer



SHURflo highly recommends the use of the Extreme™ Series High Flow Strainer, engineered to compliment the higher performance of the Smart Sensor™, to keep your Extreme™ Series Pumps flowing strong by protecting it from debris in the water. Easy installation and even easier to clean.



SAW Part No.	SHURflo Part No.	Description	R.R.P
23988	254-266	50 Mesh Screen. Protects Pumps from Harmful Debris. High Capacity, Rugged Nylon Housing with Clear Twist Off Polyamide Bowl and Easy to Clean Slide Out Screen.* For Use with Extreme™ Smart Sensor™ 5.7 Pumps Only.	\$65.20

3 YEAR WARRANTY

Extreme™ Series High Flow System



The most advanced systems available. These fully-automatic, quiet units deliver water smoothly and consistently. Self-priming, corrosion-resistant and NSF certified tank (Pump/Accumulator Combos).



SAW Part No.	SHURflo Part No.	Voltage	Max. Flow GPM/LPM	Amps (Max)	Shut-Off Pressure	R.R.P
23960	5907-5304	12 VDC	10 GPM (37.8 LPM)	12/14	60 PSI (4.1 BAR)	\$1059.90
23961	5907-6304	24 VDC	10 GPM (37.8 LPM)	5/6	60 PSI (4.1 BAR)	\$1120.10

WASHDOWN pumps

Extreme™ ProBlaster™ Washdown Pump



3 YEAR WARRANTY

The Extreme™ ProBlaster™ delivers over 20 litres per minute and pressure up to 45 psi, giving you the ultimate in washdown capabilities. This high volume pump will clean your deck quickly and easily. The corrosion resistant coated seamless motor shell with sealed switch provides excellent protection against the harsh marine environment. The Extreme™ Pro Blaster™ is designed for the toughest washdown applications! Thermally protected. Ignition protected.

SAW Part No.	SHURflo Part No.	Voltage	Dimensions	Flow Rate GPM/LPM	Amps (Max)	Shut-Off Pressure	R.R.P
23939	5901-2212	12 VDC	9.25" x 5.0" x 5.50" (235 x 127 x 140mm)	5.3 GPM (20.1 LPM)	14	45 PSI (3.1 BAR)	\$440.00



Washdown Pumps



1 YEAR WARRANTY

Perfect for tough washdown applications, such as fish box, scaling, and anchor chain cleaning, these rugged self-priming pumps deliver high lift, can run dry without damage, and won't overheat with extended use. Pumps are ignition protected and switches are sealed against water damage. Thermally protected. Ignition protected.

NOTE: PART NO. 23941 IS THE SAME PUMP AS 23940 BUT COMES WITH RETAIL PACKAGING

SAW Part No.	SHURflo Part No.	Voltage	Dimensions	Flow Rate	Amps (Max)	Shut-Off Pressure	R.R.P
23940	3901-2204	12 VDC	7.6" x 5.0" x 4.6" (203 x 127 x 118mm)	3.5 GPM (13.2 LPM)	6	45 PSI (3.1 BAR)	\$228.90
23941	3901-2214	12 VDC	7.6" x 5.0" x 4.6" (203 x 127 x 118mm)	3.5 GPM (13.2 LPM)	6	45 PSI (3.1 BAR)	\$253.50
23942	3901-3204	24 VDC	7.6" x 5.0" x 4.6" (203 x 127 x 118mm)	3.5 GPM (13.2 LPM)	3	45 PSI (3.1 BAR)	\$281.70



Washdown Kit



2 YEAR WARRANTY

SHURflo's new washdown kit includes everything you need for tough washdown applications all in one box. The kit includes the Next Generation ProBlaster™ Pump, Fittings, Blaster™ Nozzle, Raw Water Strainer and a 25' coiled hose.

Accessories Included: 25'- 3/8" [7.6 m] Self-Coiling Hose. Spray Nozzle & Fittings.

SAW Part No.	SHURflo Part No.	Voltage	Dimensions	Flow Rate	Amps (Max)	Shut-Off Pressure	R.R.P
23953	4903-4282	12 VDC	8.3" x 5.3" x 5.0" (210 x 136 x 127mm)	4.0 GPM (15.1 LPM)	6	45 PSI (3.1 BAR)	\$387.20



Raw Water Strainers

SHURflo's family of Raw Water Strainers are built to keep your bait tank, livewell and washdown pumps protected from harmful debris. The Raw Water Strainer features a clear twist off bowl and removable stainless steel screen, which allows for easy inspection and cleaning. An integral o-ring creates a tight seal, eliminating possible leaks. Keep your pumps and components lasting longer by protecting them with the SHURflo Raw Water Strainer.

Specifications: 50 Mesh Screen. Protects Pumps from Harmful Debris. High Capacity, Rugged Nylon Housing with Clear Twist Off Polyamide Bowl and Easy to Clean Slide Out Screen.

SAW Part No.	SHURflo Part No.	Size	R.R.P
23984	253-220-01	3/4"	\$59.90
23986	253-320-01	1"	\$112.70



LIVEWELL pumps



2 YEAR WARRANTY

Pro Baitmaster Heavy Duty Livewell Pump

The Pro Baitmaster™ is excellent for livewell or washdown applications in harsh marine environments. The SHURCote II seamless motor shell and sealed switch protects the pump from splashed liquids. Self-priming and can run dry without damage. Thermally protected. Ignition protected.

Specifications: 12 & 24 VDC Continuous Duty, 45 PSI, Splashproof, Sealed Motor, Ignition Protected.



SAW Part No.	SHURflo Part No.	Voltage	Suits Tank Size litres	Dimensions	Port Size Inlet/Outlet	Flow Rate	Amps (Max)	R.R.P
23943	4901-6212	12 VDC	135 (and under)	9.25" x 5.3" x 5.0" (235 x 136 x 127mm)	1/2" MSPT+	4 GPM (15.1 LPH)	9	\$387.20
23944	4901-7212	24 VDC	135 (and under)	9.25" x 5.3" x 5.0" (235 x 136 x 127mm)	1/2" MSPT+	4 GPM (15.1 LPH)	5	\$422.40

2 YEAR WARRANTY

Piranha™ Angled Port Aerator Pumps



Smart. Reliable. Attractive. Efficient. Our tough, high density nylon housing & heavy duty water cooled motor give the SHURflo Livewell Pumps unparalleled reliability. Patented anti-airlock feature allows the pump to clear trapped air in rough water or when the boat is anchored. The dual port fitting allows for easy washdown pump connections.

Specifications: Removable Cartridge, Anti-Airlock, Tough Nylon Housing, Washdown Port Connection, Submersible, Tinned 6' Wire Assembly, Ignition Protected ISO 8846



SAW Part No.	SHURflo Part No.	Voltage	Dimensions	Port Size Inlet/Outlet	Flow Rate	Amps (Max)	R.R.P
23031	357-014-10	12 VDC	7" x 7.5" (178 x 191mm)	3/4" (19mm) Inlet 3/4" (19mm) Outlet	600 GPH (2270 LPH)	2	\$105.60
23029	357-114-10	12 VDC	7" x 7.5" (178 x 191mm)	3/4" (19mm) Inlet 3/4" (19mm) Outlet	800 GPH (3027 LPH)	4.5	\$116.20

3 YEAR WARRANTY

SHURflo® Livewell Fill Valve



Keep your bait alive. The SHURflo® Livewell Fill Valve creates an energized environment that "keeps your bait alive." The full port fittings (3/4" or 1-1/8") assure the amount of flow required is achieved and maintained. The adjustable flow valve allows you to adjust the water flow to your desired amount.

Specifications: Nylon Construction, 3/4" Full Port, Low Profile Design.



SAW Part No.	SHURflo Part No.	Port Size	R.R.P
23034	330-010	3/4" Full Port	\$39.10

BLOWERS

in-line



3 YEAR WARRANTY

YellowTail™ In-Line Blowers

SHURflo has developed a unique nylon fan that includes 6 blades to ensure high performance and efficient ventilation. Installation of the Yellowtail™ Blower is made easy with extended barbs and slotted mounting bracket.

Specifications: 12 VDC, CE, Continuous Duty, ISO 9097 Marine, Ignition Protected, USCG 183.410 Compliant, NMMA Type Accepted, ABYC.



SAW Part No.	SHURflo Part No.	Description	Voltage	Dimensions	CFM	AMPS	R.R.P
39653	277-3110	3" YellowTail™ Blower	12 VDC	5.1" x 5.5" x 3.8" (130 x 140 x 96mm)	120	3.8	\$48.40
39654	277-4110	4" YellowTail™ Blower	12 VDC	5.1" x 6.4" x 4.8" [130 x 162 x 122mm]	220	5.5	\$52.30

BILGE

pumps

SHURflo® 500 - 1000 GPH Bilge Pumps



3 YEAR WARRANTY

Quality bilge pumps you can trust. SHURflo® bilge pumps are built for the harsh marine environment to withstand the toughest conditions. Standard with 3' Tinned Wire Assembly for below waterline installations and water cooled motors for extended life.

Specifications: Continuous Duty. Submersible with 3' Tinned Wire Assembly. Anti-Airlock. Tough Nylon Housing. Ignition Protected. ISO 8849.

SAW Part No.	SHURflo Part No.	Voltage	Dimensions	Round Footprint	Port Size Outlet	Flow Rate GPH/LPH	Amps (Max)	R.R.P
232100	355-010-10	12 VDC	4.2" x 3.75" (114 x 95mm)	2-3/8" (86mm)	3.4" (19mm)	500 GPH (1893 LPH)	1.8	\$38.80
232102	355-100-10	12 VDC	4.2" x 3.75" (114 x 95mm)	2-3/8" (86mm)	1-1/8" (29mm)	1000 GPH (3785 LPH)	3.2	\$45.80



SHURflo® 1500 - 2000 GPH Bilge Pumps



3 YEAR WARRANTY

Heavy duty and built to last. SHURflo's 1500 and 2000 GPH nylon bilge pumps offer a unique motor cooling system (patent pending) to ensure efficient performance and long life. Installation is a snap with our patented swivel base and 6' tinned wire assembly.

Continuous Duty. Submersible with 6' [1.8 m] Tinned Wire Assembly. Anti-Air lock. Swivel Baseplate. Ignition Protected. ISO 8849.

SAW Part No.	SHURflo Part No.	Voltage	Dimensions	Port Size Outlet	Flow Rate GPH/LPH	Amps (Max)	R.R.P
232104	358-000-10	12 VDC	7.2" x 6.0" (184 x 154mm)	1-1/8" (Outlet Barb)	1500 GPH (5677 LPH)	8	\$147.90
232106	358-010-10	12 VDC	7.2" x 6.0" (184 x 154mm)	1-1/8" (Outlet Barb)	2000 GPH (7569 LPH)	10	\$176.00
232108	358-110-10	24 VDC	7.2" x 6.0" (184 x 154mm)	1-1/8" (Outlet Barb)	2000 GPH (7569 LPH)	5	\$193.60



SHURflo®
Pentair Water

Marine Blowers

Angled Port Aerator Pumps

Extreme Washdown Pumps

SHURflo know that producing and providing **QUALITY PRODUCTS, MAXIMUM VALUE, and UNMATCHED RELIABILITY** is the surest way to satisfied customers and a leading reputation...

**Maximum performance.
Unmatched reliability.**

WATERGUARD™

filtration

1 YEAR WARRANTY



11" In-Line Water Filter

Whether under the sink, as an ice maker filter, or even connected to a garden hose, these easy-to install and highly effective 11" In-Line filters are the perfect choice for marine or home use. Long-life water-washed coconut shell carbon eliminates odor and taste and reduces chlorine.

Specifications: 2.5"x11" In-Line Filter (64 x 279mm)

SAW Part No.	SHURflo Part No.	Chlorine Reduction	Filters Up To Gallons/Litres	Flow Rate	Pressure Min/Max	Filter Size and Fitting	R.R.P
23989	RV-210BRB-A	95%	6000 (27000 L)	2.5 GPM (9.5 LPM)	20/125 PSI (1.38/8.62 BAR)	11" [279mm] Filter, 1/2" [13mm] Barb Ends	\$81.00

PUMP

fittings

Straight Fittings



SAW Part No.	SHURflo Part No.	Style	Material	Description	R.R.P
23963	244-2926	Wingnut Swivel	Nylon	1/2"-14 NPT (F) x 1/2" Barb	\$6.20
23964	244-2946	Wingnut Swivel	Nylon	1/2"-14 NPT (F) x 3/4" Barb	\$4.00

Elbow Fittings



SAW Part No.	SHURflo Part No.	Style	Material	Description	R.R.P
23966	244-3926	Wingnut Swivel	Nylon	1/2"-14 NPT (F) x 1/2" Barb	\$6.20
23967	244-3946	Wingnut Swivel	Nylon	1/2"-14 NPT (F) x 3/4" Barb	\$4.00

GENERAL PURPOSE

pump

1 YEAR WARRANTY



Drill Pump

Incorporating SHURflo's advanced motor technology that includes thermal overload protection, these pumps are self-priming, easy to install and are extremely versatile—perfect for a variety of uses including winterizing, oil changing and liquid transfer.

NOTE: Great for oil changes and other liquid transfers

SAW Part No.	SHURflo Part No.	Description	Flow Rate	Port Size	R.R.P
23947	3010-000	1/4" (6mm) Drill Shaft - Flexible BUNA Impeller. 8' (2.4m) Prime.	3.5 GPM (13.2 LPM)	3/4" GSH M	\$32.10

WATER SYSTEM accessories

Water System Accessories

Designed for safety and convenience, SHURflo accessories are built to last. Big protection from small, yet essential products.

Specifications: Easy Assembly. Keeps Debris Out of Pump. Transparent, Easy to See when Strainer Needs Cleaning. 50 Mesh Stainless Steel Screen.

1 YEAR WARRANTY



SAW Part No.	SHURflo Part No.	Description	Port Size	R.R.P
23955	255-313	Twist-On Water Strainer	1/2" [13mm] Pipe Inlet	\$21.20

Pre-Pressurised Accumulator Tank

Reduce cycling pulsation and pressure spikes, increase the life of your pump—and even save battery power. Easily handles pressure requirements from 20 PSI to 125 PSI.

1 YEAR WARRANTY



SAW Part No.	SHURflo Part No.	Description	Dimensions	Total Volume	Maximum PSI	Precharged	R.R.P
23959	182-200	24 oz. Nylon Tank	9.1" x 4.8" x 3.8" (232 x 121 x 97mm)	24 oz. (710 ml)	125 PSI (8.8 BAR)	30 PSI (2.0 BAR)	\$116.20

In-Line Check Valve

1 YEAR WARRANTY



SAW Part No.	SHURflo Part No.	Description	Port Size	R.R.P
23958	340-001	Allows Flow in One Direction Only to Safeguard Against Backsurge up to 100 PSI (6.8 BAR)	9.1" x 4.8" x 3.8" (232 x 121 x 97mm)	\$32.40

SPARE

parts

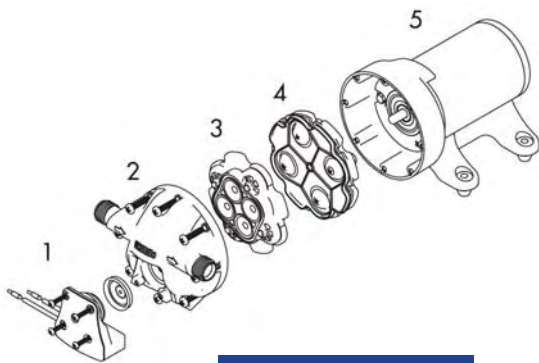

Number	Description
1	Switch
2	Upper Housing
3	Valve Assembly
4	Drive Assembly
5	Motor

Part No.	Description	R.R.P
SP-221	Valve pump assembly T/S 2088 series	\$42.30
SP-222	Pressure switch & upper housing T/S 2088 series standard	\$105.60
SP-226	Pump head repair kit T/S 2088 series standard	\$162.00
SP-228	Pump head repair kit T/S 2088	\$176.00
SP-230	Pressure switch assembly T/S 3901-2901 series	\$102.10
SP-232	Upper housing T/S 3901-2901 series	\$63.40
SP-234	Valve assembly T/S 3901-2901 series	\$93.30
SP-236	Drive & diaphragm assembly T/S 3901-2901 series	\$125.00
SP-238	Pressure switch assembly T/S 4901 series	\$100.40
SP-240	Upper housing T/S 4901 series	\$89.80
SP-242	Valve assembly T/S 4901 series	\$105.60
SP-244	Drive & diaphragm assembly T/S 4901 series	\$137.30
SP-246	Pressure switch assembly T/S 5901 series	\$102.10
SP-248	Upper housing T/S 5901 series	\$59.90
SP-250	Valve assembly T/S 5901 series	\$112.70
SP-252	Drive & diaphragm assembly T/S 5901 series	\$144.40



SAM ALLEN WHOLESale

385 Thynne Road, Morningside QLD 4170

Phone: 07 3902 7222

Fax: 07 3899 1079

Email: sales@samallen.com.au

Web: www.samallen.com.au

Catalogue Information

The product information detailed within this publication may represent only a portion of the products, as new products and upgraded specifications may be added at a later date without notification.

Sam Allen Wholesale reserves the right to add to, or delete from, or change the specifications of any products featured in this catalogue without prior notification. All product information detailed in this catalogue publication is, to the best of our knowledge and belief, correct at time of print.

Sam Allen Wholesale shall not accept any liability of any kind arising out of misuse of any product, or use for any other purpose than its intended use as indicated in this catalogue.